

- 1

Tiles: Petersen Tegl Cover C36 Tiles or similar approved
- 2

Brickwork: Vandersanden Rega brick in strecher bond or similar approved
- 3

Bespoke Hatch and Window: Composite timber and aluminium window system with treated timber opening light/vent.
- 4

Window and Doors: Composite aluminium/timber frames.
- 5

Landscaping: Landscaping design as outlined in Design Access Statement
- 6

Bin and Bike Storage: Sheltered bin and bike storage in compliance with Local Plan
- 7

Railing: 1m high cast iron railing at front of houses.
- 8

Bin and Bike Storage: Private entrance to bin and bike storage for residents

- 9

Proposed Subtation : New substation proposal as required due to removing existing substation to create amenity space for residents.
- 10

Balcony: Galvanized steel flat railings with matching handrail. PPC aluminium applied to underside and face of balconies.

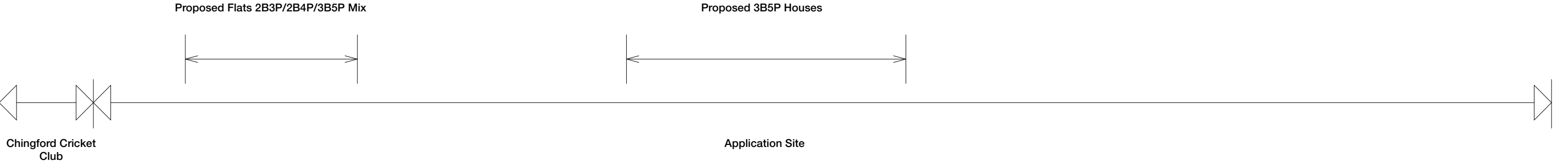
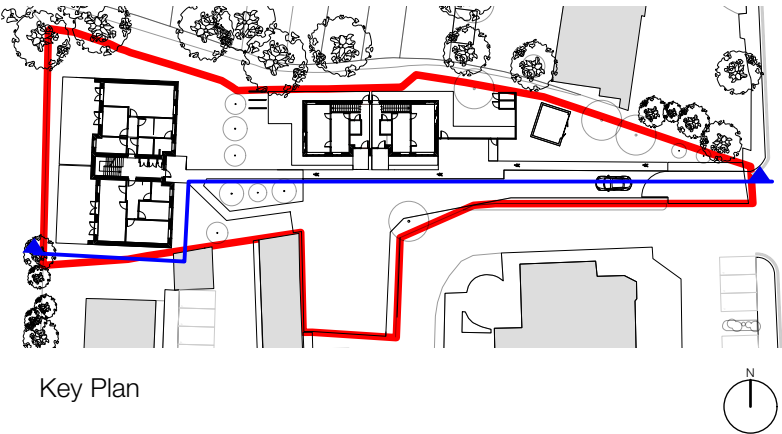

<div>General Notes</div> <div>© Copyright Stephen Davy Peter Smith Architects 2022</div> <div>These proposals are subject to the approval of all Statutory Building Control requirements and the requirements of all Statutory Authorities and Service Providers.</div> <div>The site boundaries and surroundings are based on the following topographical survey conducted by Laser Surveys.</div> <div><ul style="list-style-type: none"><li></li></ul></div> <div>The site boundaries are those described by the client.</div> <div>These drawings are to be read in conjunction with all other relevant documentation produced by Stephen Davy Peter Smith Architects and other consultants employed by the client.</div>	<div>Specific Notes</div> <div><div><div></div><div></div></div>Site Boundary</div>	<div>Key</div> <div><div>1:250</div><div><div></div><div>0</div><div>2</div><div>4</div><div>6</div><div>8</div><div>10</div><div>12m</div></div></div>	P4	Updates to flats and landscaping	03/03/23	Client	Forest Side Real Estate Ltd	stephen davy peter smith architects	Drawing Ref.	2126 - DS - 01 - GF - DR - A - P208	Job No.	2126
			P3	Changes to brick	07/09/22				Purpose of Issue	PLANNING	Scale	1:250 @ A3
			P2	Addition of new substation	16/06/22				Drawing Title Proposed South Elevation Cranked			
			P1	Substation Location	21/03/22							
			Rev	Drawn	Notes				Date		A - APPROVED	Project
			P4				03/03/23		B - APPROVED WITH COMMENTS	Forest Side		
			Rev	Checked	Date	Approved	Date		C - DO NOT USE			
			REVISIONS						CLIENT APPROVAL			

Project Ref - Drawing No - Status - Revision			
2126 - P208 - S2 - P4			